



Cleveland Metroparks®

FIND YOUR PATH

First Tee Cleveland
Facility Expansion Proposal
Washington Golf Course

August 19, 2021

First Tee Cleveland – Facility Expansion Proposal – Washington Golf Course



2003 Use and Operation Agreement

- 30 Year Term Initial Term with ability to extend twice for 30 years each extension
- Established cost share scenario for initial construction
- Provided First Tee Cleveland “priority usage” of the facility
- Established responsible parties for operational costs



First Tee Cleveland – Facility Expansion Proposal – Washington Golf Course

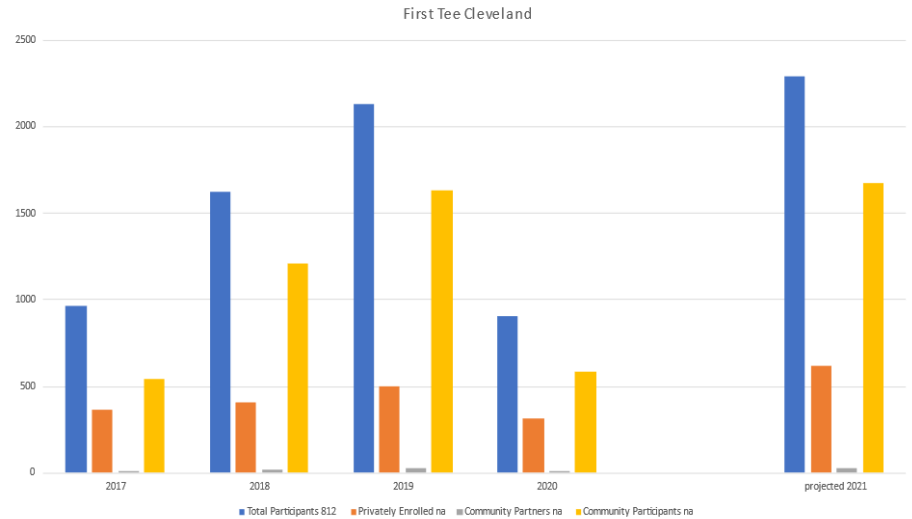

First Tee Cleveland – Facility Expansion Proposal – Washington Golf Course

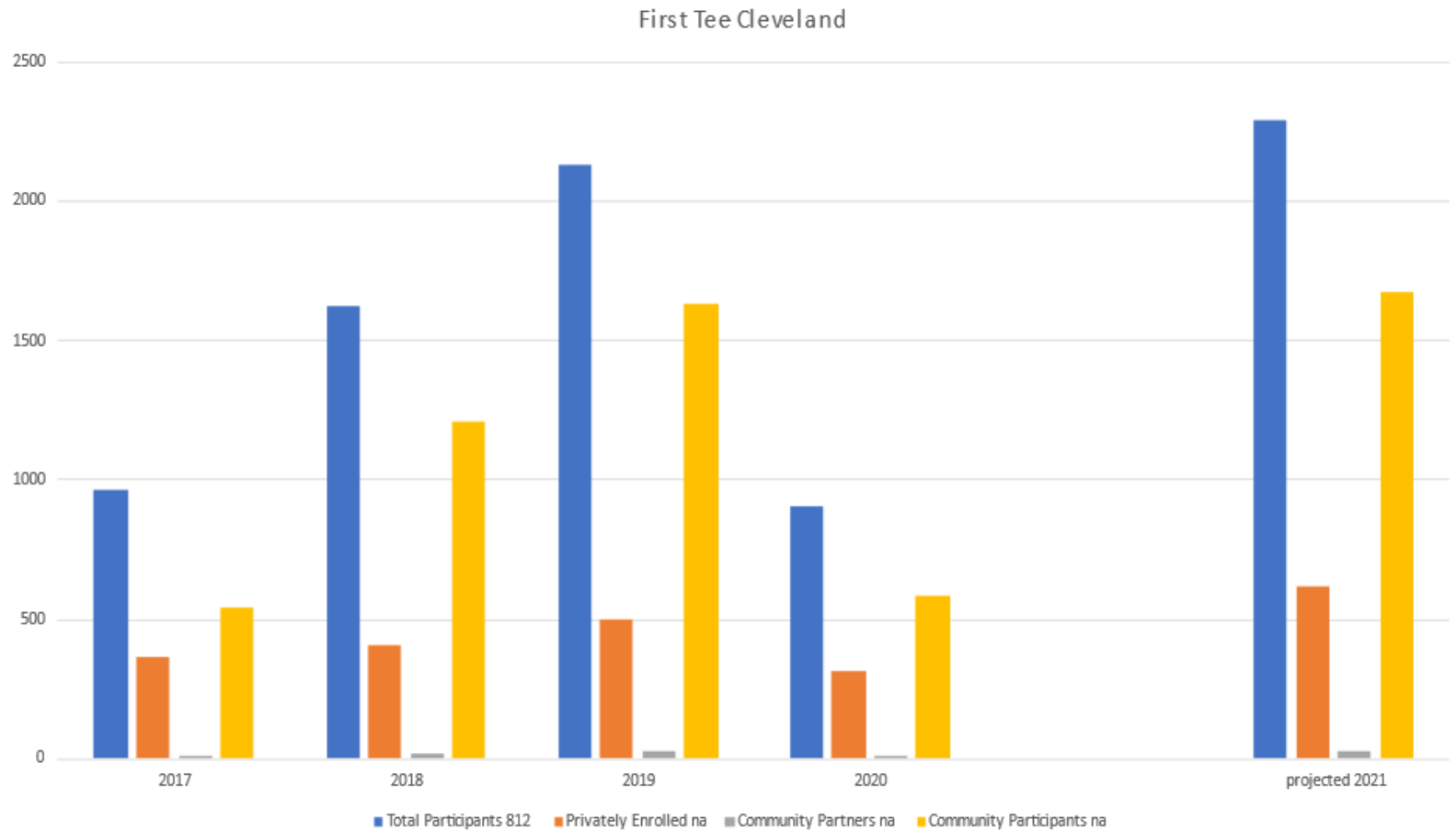

| | 2016 | 2017 | 2018 | 2019 | 2020 | 2021 Est. |
|---------------------------|------|------|------|------|------|-----------|
| Total Participants | 812 | 962 | 1623 | 2128 | 906 | 2291 |

First Tee Cleveland – Facility Expansion Proposal – Washington Golf Course



| Community Partners 2021 | |
|-----------------------------------|---------|
| | Approx: |
| Black Brook Golf Camp | 30 |
| CLE Metroparks Camp - Washington | 100 |
| Cleveland Parks and Recreation | 16 |
| Cuyahoga Heights Boys Golf Team | 10 |
| Cuyahoga Heights Girls Golf Team | 10 |
| High Tech Adacemy | 50 |
| Ridgewood Camp | 75 |
| Cleveland Heights Girls Golf Team | 6 |
| A.B. Hart (Fullerton) | 50 |
| CLE Clinic Pain rehab | 20 |
| PGA Junior League | 50 |
| America Scores | 20 |
| Halle School (H.B. Booker School) | 50 |

| | |
|-------------------------------------|-----|
| Harvey Rice Elementary | 50 |
| Kids Kicking Cancer | 20 |
| Jones Road Family Development | 80 |
| Mayfield Heights Rec Center | 30 |
| Miles Park Elementary | 80 |
| US Kids Golf | 25 |
| Newton D. Baker School | 50 |
| Open Doors Academy | 50 |
| Parma Community Intermediate School | 250 |
| Richmond Heights Elementary | |
| Shaker Heights Middle School | |
| University Settlement | |

| | |
|------------------------------------|-----|
| Urban Community School | 100 |
| Warner Girls Leadership Academy | 70 |
| Washington Park Community School | 100 |
| St. Thomas More | 30 |
| Welsh Academy at St. Ignatius | 45 |
| Family First partnership | 15 |
| CMSD Golf and Leadership camp | 50 |
| CMSD Summer Experience - Harvey R. | 100 |
| CMSD Summer Experience - AB Hart | 100 |
| CMSD Summer Experience - Mound | 100 |
| Jack and Jill Group | NA |
| Alpha Esquires | NA |
| Wade Park Learning Pod | NA |
| Giddeons Army | 20 |
| St. Angela Merici | NA |
| Almira Learning Pod | 16 |



First Tee Cleveland – Facility Expansion Proposal – Washington Golf Course



First Tee Cleveland – Facility Expansion Proposal – Washington Golf Course



First Tee Cleveland – Facility Expansion Proposal – Washington Golf Course

Proposed Project Components

- Multi-Purpose Room
- Golf Simulators (2)
- Learning Center
- Kitchen
- Storage

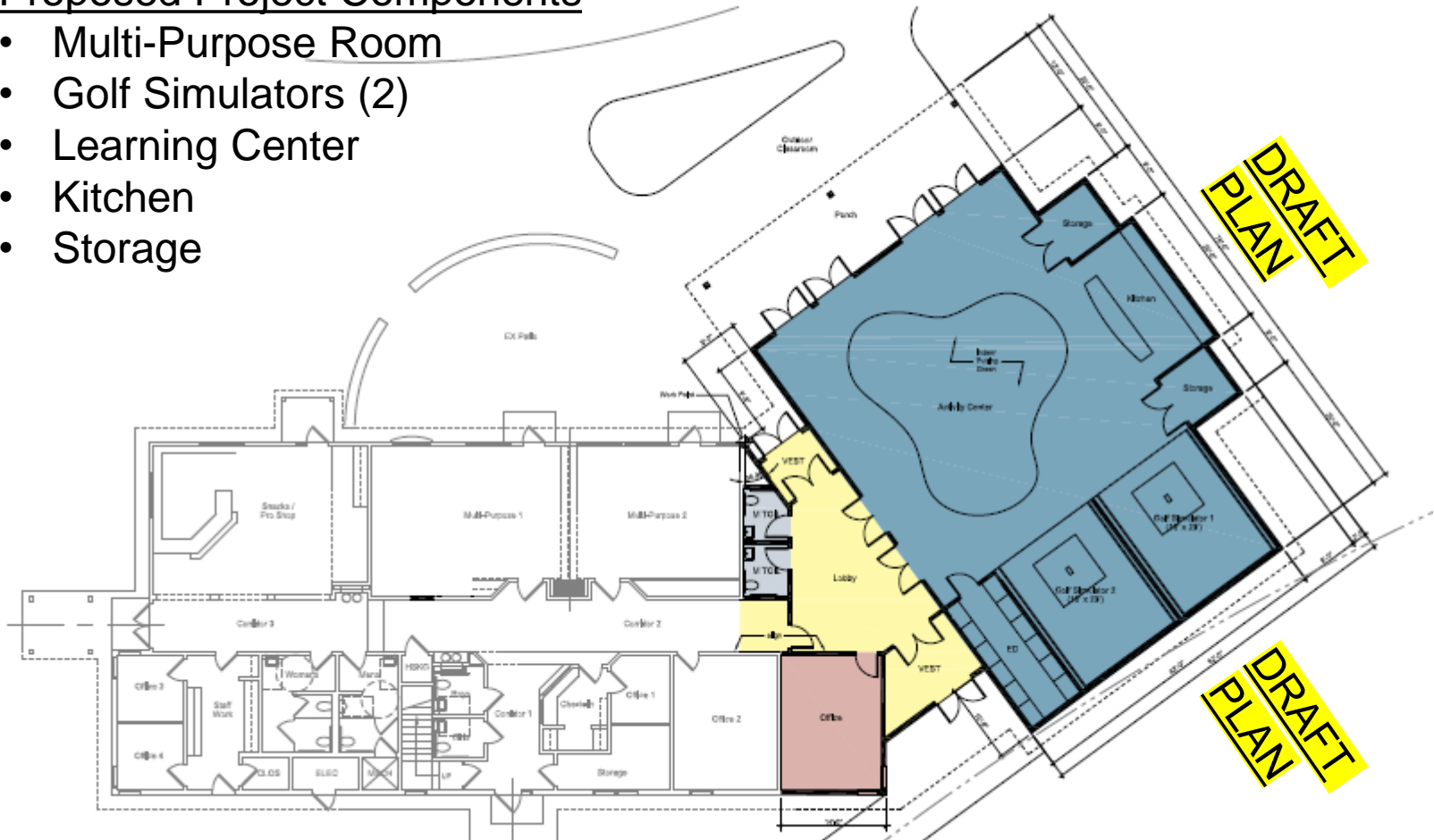

First Tee Cleveland – Facility Expansion Proposal – Washington Golf Course



First Tee Cleveland – Facility Expansion Proposal – Washington Golf Course

Project Development Agreement Draft Format:

- Establish Project Delivery Format – Construction Manager At Risk
- Metroparks establishes w/First Tee Approval
 - Design Team
 - Contractor
- Metroparks staff manages process and construction in partnership with First Tee Cleveland
- First Tee Cleveland responsible for all costs and prepared to make \$3M investment





Cleveland Metroparks®

FIND YOUR PATH

First Tee Cleveland
Facility Expansion Proposal
Washington Golf Course

August 19, 2021